

## FOR STANDARD EUROPEAN GROUP 3 PUMPS

ML 52 Series Pump Drive Step-up Gearboxes provide the connection for a hydraulic pump to the low speed tractor Power Take-off shaft.

The standard power take-off speed, 540 RPM, is increased to the optimum speed conditions for the pump. Consequently a smaller and less costly pump can be utilised that will provide the same flow as a considerably larger direct driven pump. In addition because the pump is being driven at an optimum speed the pump will have a greater increased overall efficiency and service life compared to most standard pumps which are not designed to operate at 540 RPM.

ML 52 Series Gearboxes interface with Standard European Group 3 mount pumps.

### TECHNICAL SPECIFICATIONS

Maximum Output Speed.....	3000 RPM
Speed Increase Ratio.....	1:3
Maximum Continuous Torque Output.....	161 Nm. (118 ft lbs.)
Maximum Intermittent Torque Output.....	201 Nm. (185 ft lbs.)
Maximum Continuous Power @ 540 RPM (Input) .....	27 Kw. (36.5 HP)
Input Shaft.....	Female 1 3/8" DIN 9611
Output Interface.....	See Dimensional Detail data for options available
Working Temperature .....	-20°C to + 80°C
Gearbox Oil (Lubrication) .....	SAE 90
Weight .....	7.8 Kg

### DIMENSIONAL DETAILS mm (inches)

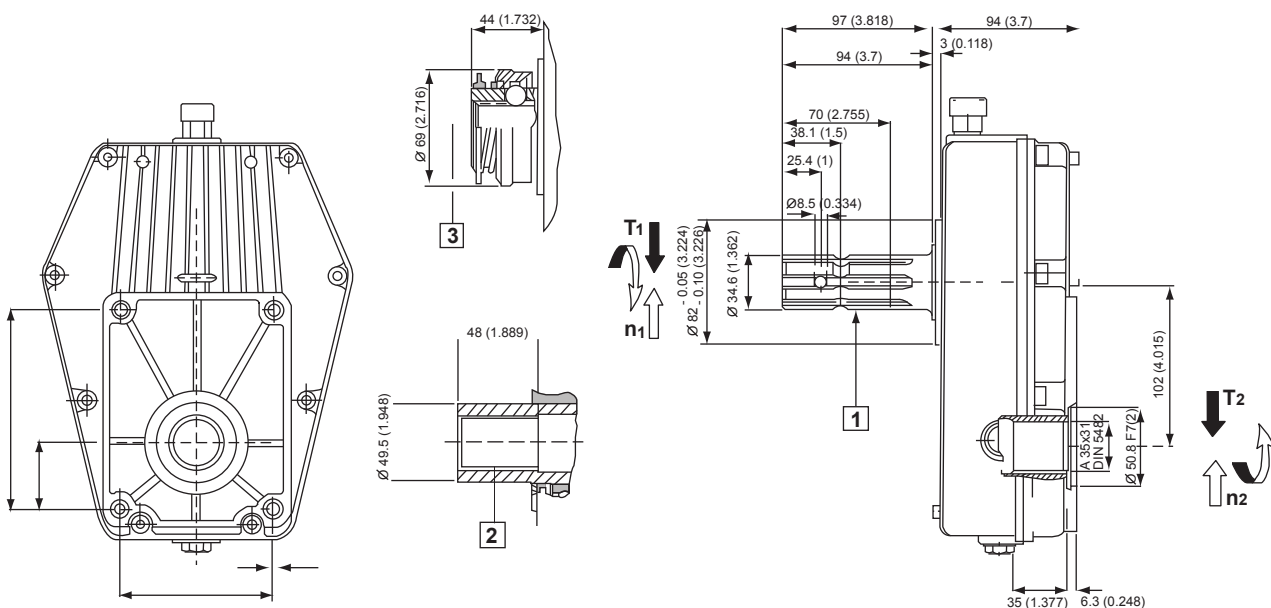

**NOTE: INPUT SHAFT #2 IS STANDARD**

# ML52 Series

Pump Drive Gearboxes



## DIMENSIONAL DETAILS mm (inches)

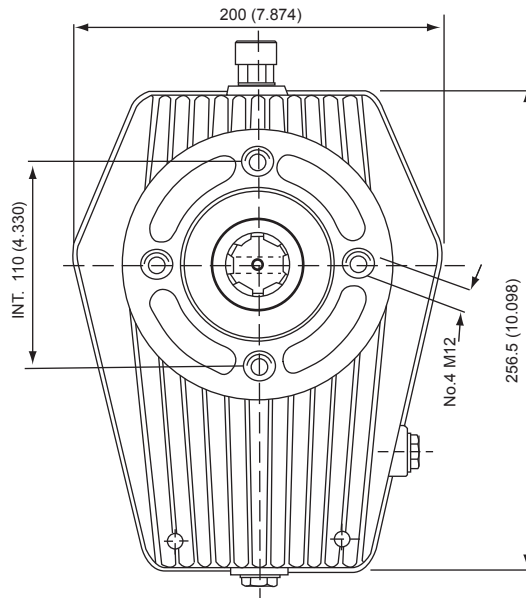

**NOTE:** Gearboxes are supplied complete with Part No. 31003500 Splined Adaptor which interfaces with the standard 18.61mm dia, 1:8 Taper x 4.0mm keyway Standard Group 3 Pump shaft and the female splined drive shaft in the gearbox.

## SERVICE NOTES

Correct lubrication is the determining factor for long gearbox life. The gearbox should be filled with a SAE 90 specification gear oil to the level indicated in the sight glass. This level should be checked frequently to ensure that it is maintained.

The oil should be changed after the first 30 - 50 hours of operation and subsequently changed every 12 months.

## HOW TO ORDER

ML52  
Series Code

-

2

CODE No.	INPUT SHAFT SPECIFICATION
1	Male 1-3/8" Dia x 6T DIN 9611
2*	Female 1-3/8" Dia x 6T DIN 9611
3	Female 1-3/8" Dia x 6T DIN 9611 with 'Quick Disconnect' adaptor

\* Standard