

RD52 Series

Pump Drive Gearboxes

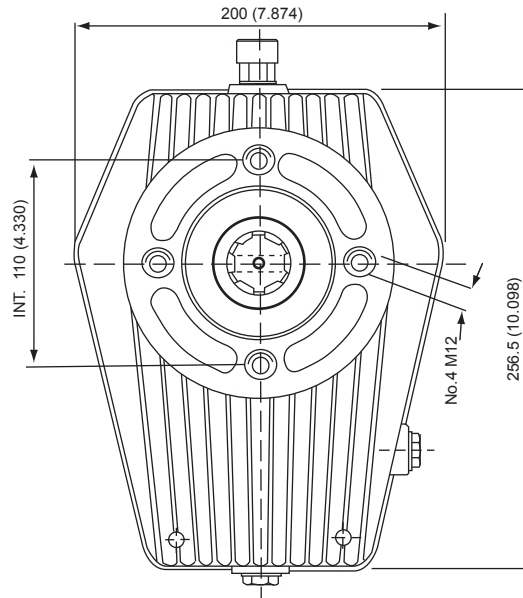

DIMENSIONAL DETAILS mm (inches)



NOTE: Gearboxes are supplied complete with Part No. 31025700 Splined Adaptor which interfaces with the standard 7/8" dia, x 1/4" - 3/16" key way Pump shaft and the female splined drive shaft in the gearbox. Splined adaptor Part No. 31004400 to suit a pump shaft 7/8" dia. x 13 T spline is available as an option on request.

SERVICE NOTES

Correct lubrication is the determining factor for long gearbox life. The gearbox should be filled with a SAE 90 specification gear oil to the level indicated in the sight glass. This level should be checked frequently to ensure that it is maintained.

The oil should be changed after the first 30 - 50 hours of operation and subsequently changed every 12 months.

HOW TO ORDER

RD52	-	B
Series Code		B = SAE 'B' 2- Bolt Pump Mount