

VS 150 Series

Solenoid Operated Selector Valves



Max flow	50-60 l/min	Code	L 7 2 1 U J W V * Y Z
Max pressure	310 bar	Model	VS 151/152/155
Ports	3/8" G-1/2" G-SAE 8		
Description: 6 way flow diverters			

CIRCUIT					
Code	Circuit	* Transit position	Code	Circuit	* Transit position
W			W		
6A			6F		
6B			6G		
6E					

TECHNICAL FEATURES										
V	Drain	Circuit	Spool types							Pressure max bar
			6A	6B	6E	6F	6G			
I	Int. D.I.		250	250	250	310	310			
E	Ext. D.E.		310	310	310	-	-			

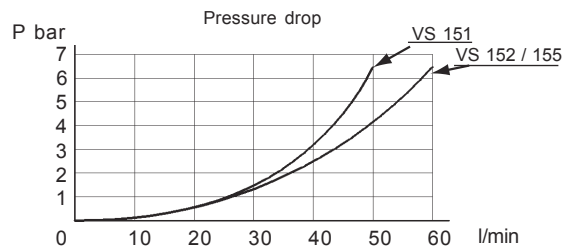
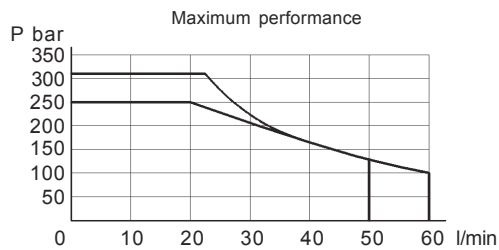

Internal leakage on C ports	MIN	MAX	Mineral oil with 32 cSt viscosity, at 40°C and 100 bar pressure.
	cm ³ /min	cm ³ /min	
	10	20	

OVER-ALL DIMENSIONS

U	Ports (A)	Model	Dimensions (mm)		
3	3/8" Gas	VS 151			
4	1/2" Gas	VS 152			
C	SAE 8	VS 155			
Weight		2.85 kg			

MAXIMUM BLOCKING TORQUES

Tube ch. 16mm: 22÷ 24Nm	Retainer nut 5÷6Nm	Fixing screws N°3 DIN 912-8.8 M6x40: 9÷ 10Nm
----------------------------	-----------------------	---

VS 150 Series

Solenoid Operated Selector Valves

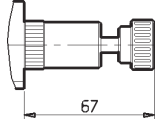
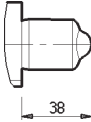
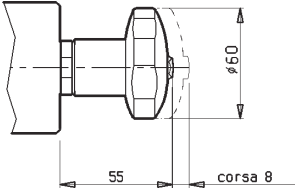
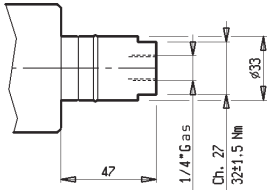

OPTIONS																	
J	Screwed manual override EF Reference: LC1DZEF			J	Push-button manual override EP Reference: 271-05099												
_F																	
	67			38													
OTHER ACTUATORS																	
J	X	Push-turn manual actuator Ref.: 26-0243000	J	X	Oleopneumatic actuator OP Reference: LC1 ZP	Pilot pressure											
H1	SG		P1	00		P. Max 200bar											
						P. Min 4bar*											
		55			47	With external drain (DE).											
		corsa 8			1/4" Gas	With internal drain (DI), allow for pilot ratio 6,5:1. Example: at 100 bar pressure (C1, C2, C3, C4), will need a minimum pilot pressure of 100:6,5 = 15,4 bar.											
		φ60			Ch. 27												
					32±1,5 Nm												
					φ33												
ORDERING CODE																	
<table border="1" style="margin: auto;"> <tr> <td>L</td><td>7</td><td>2</td><td>1</td><td>U</td><td>J</td><td>W</td><td>V</td><td>*</td><td>Y</td><td>Z</td> </tr> </table>							L	7	2	1	U	J	W	V	*	Y	Z
L	7	2	1	U	J	W	V	*	Y	Z							
U	PORTS																
-	SEE PAGE 2.158																
W	CIRCUIT																
--	SEE PAGE 2.158																
V	DRAIN																
-	SEE PAGE 2.158																
Y	CONNECTION																
00	WITHOUT COIL AND CONNECTOR																
01	WITH COIL, WITHOUT CONNECTOR																
02	WITH CONNECTOR DIN 43650																
03	AMP JUNIOR																
07	DT04-2P DEUTSCH																
31	CABLE 350 mm																
34	CABLE 350 mm + DT04-2P DEUTSCH																
Z	VERSION																
0	STANDARD																
V	SEALS IN VITON																
J	OPERATED																
11	ELECTRICALLY OPERATED (DZ)																
1F	ELECTRICALLY OPERATED + EF																
1P	ELECTRICALLY OPERATED + EP																
P1	OLEOPNEUMATICALLY OPERATED (OP)																
H1	MANUALLY OPERATED (MN)																
20*	EL. OPERATED WITH EXPLOSION PROOF COILS (AD)																
* ON REQUEST (ATEX)																	
X	VOLTAGE																
		Available connections															
		00	01	03	07	31	34										
00	WITHOUT COIL																
OB	12V DC	X	X	X	X	X	X										
OC	24V DC	X	X	X	X	X	X										
AC	27V DC	X	X		X												
OD	48V DC	X	X														
OV	24 RAC (21.5 DC)	X	X														
OW	110 RAC (98 DC)	X	X														
OZ	230 RAC (207 DC)	X	X														

VS 150 Series

Coils



COIL C48

J

1

Weight : 0.500 kg. - Insulation Class: H

Working Duty: ED 100% only if the room temperature does not exceed 40°C.

Inlet voltage: should not exceed +5% / -10% of the nominal value.

Available voltages: Look at table. On request different voltages can be supplied.

Low voltage: conforms to the 73/23/CEE and 89/336/CEE directives. Standard connections: DIN 43650-ISO 4400.

Versions with sheathed cables as well as with Deutsch and AMP JUNIOR connector are equipped with bi-directional diode.

Protection Class according to DIN 40050: only if the coil is assembled correctly with O'ring and retainer:

- IP65 with DIN 43650 connector, only if they are assembled with rubber sealings and the fixing screw is properly tightened.
- IP69k for versions with Deutsch connector.

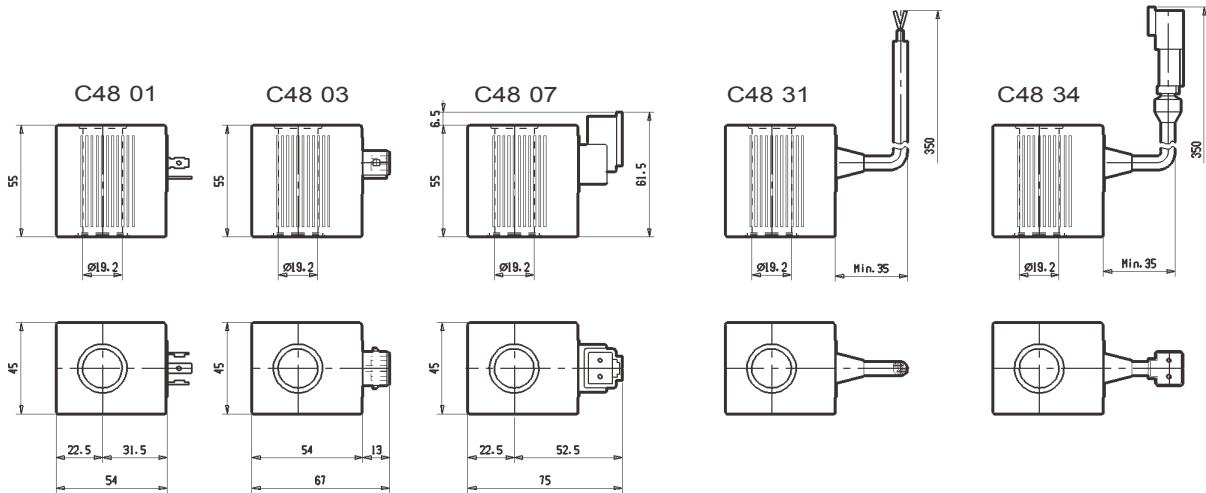

Reference	Model	Connection	Nominal voltage volt	Marking	Power watt	Nominal current ampere	Resistance #	
							± 7%	T=20°C
271-0520	C4801 12DC	DIN 43650 - ISO 4400	12 DC	12 VDC	36	3.01	4,0	
271-052000	C4831 12DC	CABLES	12 DC	12 VDC	36	3.01	4,0	
271-052001	C4834 12DC	CABLES+ DEUTSCH	12 DC	12 VDC	36	3.01	4,0	
271-052004	C4807 12DC	DEUTSCH DT04-2P	12 DC	12 VDC	36	3.01	4,0	
271-0520005	C4803 12DC	AMP JUNIOR	12 DC	12 VDC	36	3.01	4,0	
271-0521	C4801 24DC	DIN 43650 - ISO 4400	24 DC	24 VDC	36	1.53	16,0	
271-052005	C4831 24DC	CABLES	24 DC	24 VDC	36	1.53	16,0	
271-052006	C4834 24DC	CABLES+ DEUTSCH	24 DC	24 VDC	36	1.53	16,0	
271-052009	C4807 24DC	DEUTSCH DT04-2P	24 DC	24 VDC	36	1.53	16,0	
271-0520055	C4803 24DC	AMP JUNIOR	24 DC	24 VDC	36	1.53	16,0	
271-052008	C4807 27DC	DEUTSCH DT04-2P	27 DC	27 VDC	36	1.32	20,5	
271-05212	C4801 27DC	DIN 43650 - ISO 4400	27 DC	27 VDC	36	1.32	20,5	
271-0522	C4801 48DC	DIN 43650 - ISO 4400	48 DC	48 VDC	36	0.75	63,6	
271-0525	C4801 230-50/60 RAC	DIN 43650 - ISO 4400	207 DC	207 DC	36	0.17	1163,0	
271-0524	C4801 110-50/60 RAC	DIN 43650 - ISO 4400	98 DC	98 VDC	36	0.37	261,0	
271-0523	C4801 24 - 50/60 RAC	DIN 43650 - ISO 4400	21,5 DC	21,5 VDC	36	1.70	12,0	