

VS 240F Series

Solenoid Operated Selector Valves



Max flow	50 l/min	Code	L 7 3 2 U J W V * Y Z
Max pressure	310 bar		
Ports	3/8" G-SAE8 M18x1,5	Model	VS241/5/6F
Description: 6 way bankable flow diverters			

CIRCUIT					
Code	Circuit	* Transit position	Code	Circuit	* Transit position
W			W		
6B			6H		
6D			6G		
6E					

TECHNICAL FEATURES										
V	Drain	Circuit	Spool types							Pressure max bar
			6B	6D	6E	6G	6H			
I	Int. D.I.		250	250	250	310	310			
E	Ext. D.E.		310	310	310	-	-			

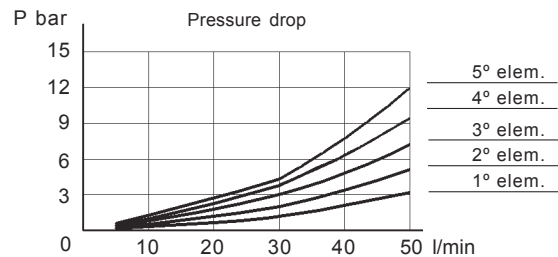
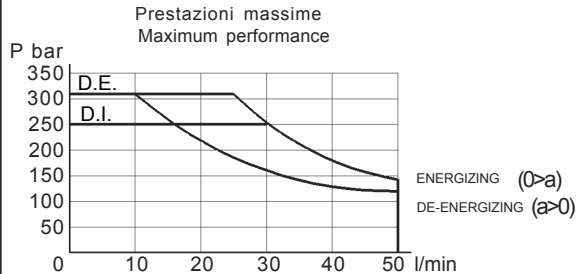

Internal leakage on C ports	MIN	MAX	Mineral oil with 32 cSt viscosity, at 40°C and 100 bar pressure.
	cm ³ /min	cm ³ /min	
	10	30	

OVER-ALL DIMENSIONS			
U	Ports (D)	Ports (E)	Model
3	3/8" Gas	1/4" Gas	VS241F
C	SAE 8	SAE 4	VS245F
Y	M18x1,5	-	VS246F
Weight		3.35 kg	

VS 240F Series

Solenoid Operated Selector Valves

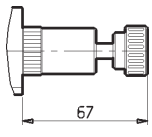
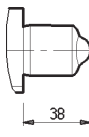
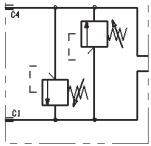
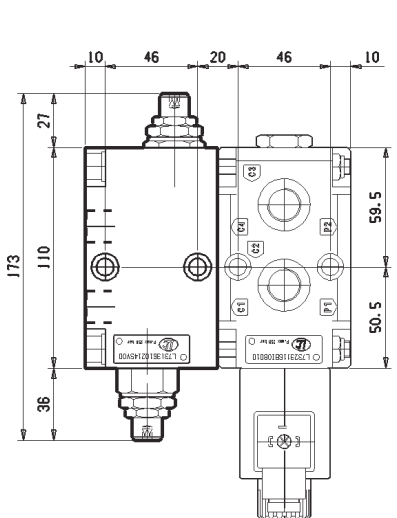
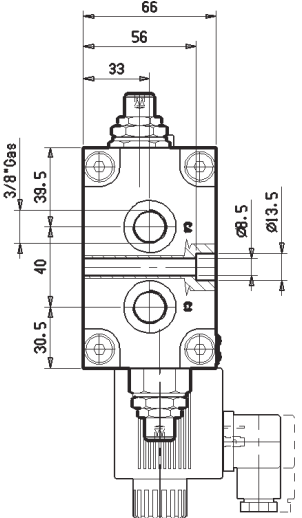
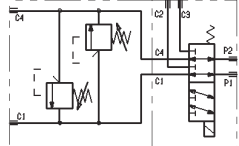
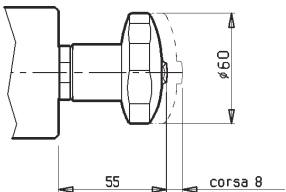
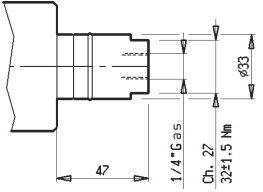

MAXIMUM BLOCKING TORQUES							
Tube ch. 16mm: 22± 24Nm		Retainer nut 5± 6Nm		Fixing screws DIN 912-8.8 M8x65: 15± 16Nm			
OPTIONS							
J	Screwed manual override EF Reference: LC1DZEF			J	Push-button manual override EP Reference: 271-05099		
_F							
STACKABLE ELEMENTS							
CIRCUIT		Ports (D)	Code	Description			
		3/8" Gas	L7313610214SV00	Stackable element with cross pressure limiting valves on C1-C4.			
		SAE8	L731C610214SV00				
				Weight	1.40 kg		
				P. max bar	Q	Cartridge	
250	50	VMD1.040.SV	EXAMPLE				
OTHER ACTUATORS							
J	X	Push-turn manual actuator Ref.: 26-0243000	J	X	Oleopneumatic actuator OP Reference: VS281P	Pilot pressure	
H1	SG		P1	00		P. Max 200bar	P. Min 4bar*
						* With external drain (DE).	
			With internal drain (DI), allow for pilot ratio 6.5:1. Example: at 100 bar pressure (C1,C2,C3,C4), will need a minimum pilot pressure of 100:6,5 = 15,4 bar.				

VS 240F Series

Solenoid Operated Selector Valves



TYPES OF MOUNTING

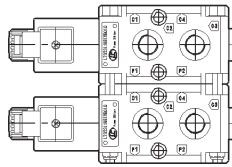
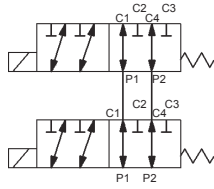

8 way

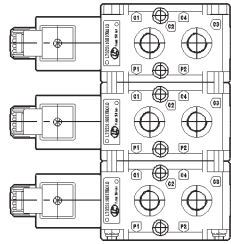

10 way

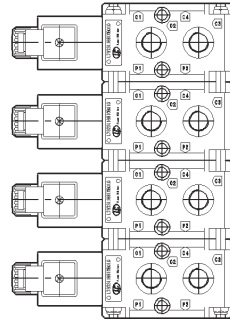

12 way

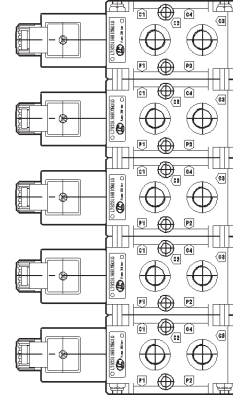

14 way

Model	Ports number	L mm	Screws - Tie rods	Maximum blocking torque Nm
VS 241/5/6F-2	8	132	M8x125 (v)	17 Nm
VS 241/5/6F-3	10	198	M8x190 (v)	17 Nm
VS 241/5/6F-4	12	264	M8x270 (t)	17 Nm
VS 241/5/6F-5	14	330	M8x330 (t)	17 Nm

ORDERING CODE

L 7 3 2 U J W V * Y Z

U	PORTS
-	SEE PAGE 2.161
V	DRAIN
-	SEE PAGE 2.161
W	CIRCUIT
--	SEE PAGE 2.161

J	OPERATED
11	ELECTRICALLY OPERATED (DZ)
1F	ELECTRICALLY OPERATED + EF
1P	ELECTRICALLY OPERATED + EP
P1	OLEOPNEUMATICALLY OPERATED (OP)
H1	MANUALLY OPERATED (MN)

Z	VERSION
0	SINGLE ELEMENT
2	2 FLANGED ELEMENTS
3	3 FLANGED ELEMENTS
4	4 FLANGED ELEMENTS
5	5 FLANGED ELEMENTS

Y	CONNECTION
00	WITHOUT COIL AND CONNECTOR
01	WITH COIL, WITHOUT CONNECTOR
02	WITH CONNECTOR DIN 43650
07	DT04-2P DEUTSCH
31	CABLE 350 mm
34	CABLE 350 mm + DT04-2P DEUTSCH

X	VOLTAGE	Available connections				
		00	01	07	31	34
00	WITHOUT COIL					
OB	12V DC	X	X	X	X	X
OC	24V DC	X	X	X	X	X
AC	27V DC	X	X		X	
OD	48V DC	X	X			
OV	24 RAC (21.5 DC)	X	X			
OW	110 RAC (98 DC)	X	X			
OZ	230 RAC (207 DC)	X	X			

VS 240F Series



Coils

COIL C48

J

1

Weight : 0.500 kg. - Insulation Class: H

Working Duty: ED 100% only if the room temperature does not exceed 40°C.

Inlet voltage: should not exceed +5% / -10% of the nominal value.

Available voltages: Look at table. On request different voltages can be supplied.

Low voltage: conforms to the 73/23/CEE and 89/336/CEE directives. Standard connections: DIN 43650-ISO 4400.

Versions with sheathed cables as well as with Deutsch and AMP JUNIOR connector are equipped with bi-directional diode.

Protection Class according to DIN 40050: only if the coil is assembled correctly with O'ring and retainer:

- IP65 with DIN 43650 connector, only if they are assembled with rubber sealings and the fixing screw is properly tightened.
- IP69k for versions with Deutsch connector.

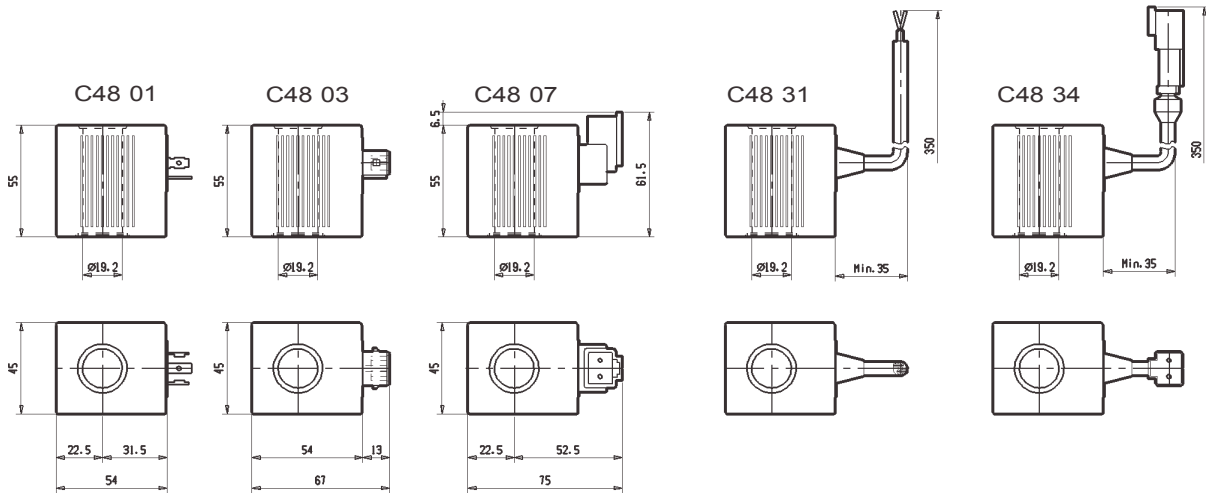

Reference	Model	Connection	Nominal voltage volt	Marking	Power watt	Nominal current ampere	Resistance #	
							± 7%	T=20°C
271-0520	C4801 12DC	DIN 43650 - ISO 4400	12 DC	12 VDC	36	3.01	4,0	
271-052000	C4831 12DC	CABLES	12 DC	12 VDC	36	3.01	4,0	
271-052001	C4834 12DC	CABLES+ DEUTSCH	12 DC	12 VDC	36	3.01	4,0	
271-052004	C4807 12DC	DEUTSCH DT04-2P	12 DC	12 VDC	36	3.01	4,0	
271-0520005	C4803 12DC	AMP JUNIOR	12 DC	12 VDC	36	3.01	4,0	
271-0521	C4801 24DC	DIN 43650 - ISO 4400	24 DC	24 VDC	36	1.53	16,0	
271-052005	C4831 24DC	CABLES	24 DC	24 VDC	36	1.53	16,0	
271-052006	C4834 24DC	CABLES+ DEUTSCH	24 DC	24 VDC	36	1.53	16,0	
271-052009	C4807 24DC	DEUTSCH DT04-2P	24 DC	24 VDC	36	1.53	16,0	
271-0520055	C4803 24DC	AMP JUNIOR	24 DC	24 VDC	36	1.53	16,0	
271-052008	C4807 27DC	DEUTSCH DT04-2P	27 DC	27 VDC	36	1.32	20,5	
271-05212	C4801 27DC	DIN 43650 - ISO 4400	27 DC	27 VDC	36	1.32	20,5	
271-0522	C4801 48DC	DIN 43650 - ISO 4400	48 DC	48 VDC	36	0.75	63,6	
271-0525	C4801 230-50/60 RAC	DIN 43650 - ISO 4400	207 DC	207 DC	36	0.17	1163,0	
271-0524	C4801 110-50/60 RAC	DIN 43650 - ISO 4400	98 DC	98 VDC	36	0.37	261,0	
271-0523	C4801 24 - 50/60 RAC	DIN 43650 - ISO 4400	21,5 DC	21,5 VDC	36	1.70	12,0	