

VS 70 Series

Solenoid Operated Selector Valves



Max flow 25 l/min		Code L700UJWVXYZ					
Max pressure 310 bar		Model VS70- VS75					
Ports 1/4" Gas-SAE4							
Description: 3 way flow diverter							
CIRCUIT							
Code	Circuit	* Transit position	Code	Circuit	* Transit position		
W			W				
3A			3N				
TECHNICAL FEATURES							
V	Drain	Circuit	Spool types				Pressure max bar
			3A	3N			
I	Int. D.I.		250	250			
E	Ext. D.E.		310	310			
<p>Maximum performance</p>		<p>Pressure drop</p>					
Internal leakage in C ports			MIN cm ³ /min	MAX cm ³ /min	Mineral oil with 32 cSt viscosity at 40°C and 100 bar pressure		
			7	15			
OVER-ALL DIMENSIONS							
U	Ports (F)	Model					
2	1/4" Gas	VS 70					
A	SAE4	VS 75					
Weight		0.90 kg					
MAXIMUM BLOCKING TORQUE							
Tube ch. 22mm: 20+22Nm		Coil retainer nut Ø e 20.5: 5÷6Nm		Fixing screws No2 DIN 912-8.8 M5x50: 5÷6Nm			
OPTIONS							
J	Screwed manual override EF Reference LC04ZEF			J	Push-button manual override EP		
_F				_P	Reference 271-05098		

VS 70 Series

Solenoid Operated Selector Valves



OTHER ACTUATORS

J	X	Oleopneumatic actuator OP Reference: LC04ZP	Pilot pressure	
P1	00		P. Max 200bar	P. Min 4bar*

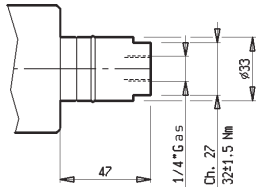

With external drain (DE).

With internal drain (DI), allow for pilot ratio 6,5:1.
Example: at 100 bar pressure (C1 or C2), will need a minimum pilot pressure of $100:6,5 = 15,4$ bar.

ORDERING CODE

L700UJWVXYZ

U	PORTS
—	SEE PAGE 2.145

J	OPERATED
10	ELECTRICALLY OPERATED (Z)
1F	ELECTRICALLY OPERATED + EF
1P	ELECTRICALLY OPERATED + EP
P1	OLEOPNEUMATICALLY OPERATED (OP)
20*	EL. OP. WITH EXPLOSION PROOF COILS (AD)

W	CIRCUIT
—	SEE PAGE 2.145

V	DRAIN
—	SEE PAGE 2.145

Z	VERSION
0	STANDARD
V	SEALS IN VITON

* ON REQUEST (ATEX)

X	VOLTAGE	Available connections					
		00	01	03	07	31	34
00	WITHOUT COIL						
OB	12V DC	X	X	X	X	X	X
AD	13V DC	X	X				
OC	24V DC	X	X	X	X	X	X
AC	27V DC	X	X				
OD	48V DC	X	X				
OE	110V DC	X	X				
OV	24 RAC (21.5 DC)	X	X				
OW	110 RAC (98 DC)	X	X				
OZ	230 RAC (207 DC)	X	X				

Y	CONNECTION
00	WITHOUT COIL AND CONNECTOR
01	WITH COIL, WITHOUT CONNECTOR
02	WITH CONNECTOR DIN 43650
03	AMP JUNIOR
07	DT04-2P DEUTSCH
31	CABLE 350 mm
34	CABLE 350 mm + DT04-2P DEUTSCH

VS 70 Series

Coils



COILS C36

J

1_

Weight: 0,210 kg
 - Insulation Class: H
 Relative duty factor: ED 100% only if the room temperature does not exceed 40°C.
 Permissible voltage fluctuation: +5% -10% of the nominal.
 Available voltages: Look at table. On request different voltages can be supplied.
 Standard Connections: DIN 43650, ISO 4400.
 Low voltage directives EEC 73/23/CEE and 89/336/CEE .
 Versions with sheathed cables as well as with Deutsch and AMP JUNIOR connectors are equipped with bi-directional diode.
 Protection Class according to DIN 40050: coil correctly assembled with O'ring and retainer:
 - IP65 with AMP JUNIOR and DIN 43650 connector, if assembled with rubber sealings and fixing screw is properly tightened.
 - IP69k for versions with Deutsch connector.

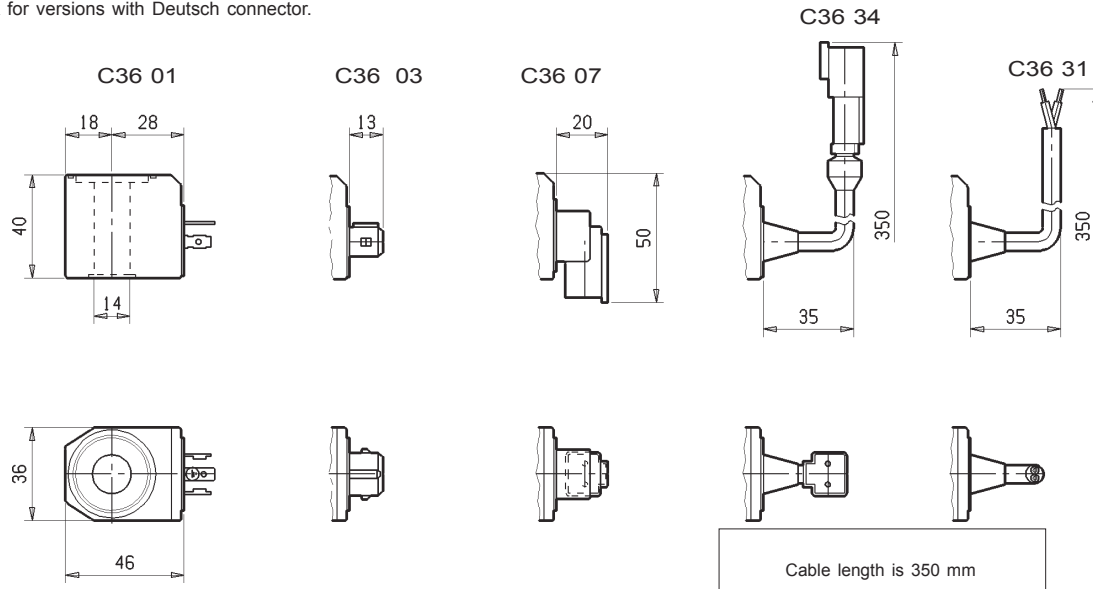

Reference	Model	Connection	Nominal voltage Volt	Marking	Power watt	Nominal current ampere	Resistance #	
							± 7%	T=20°C
271-0510	C3601 12DC	DIN 43650 - ISO 4400	12 DC	12 VDC	26	2.15	5.5	
271-0510002	C3631 12DC	CABLES	12 DC	12 VDC	26	2.15	5.5	
271-05102	C3603 12DC	AMP JUNIOR	12 DC	12 VDC	26	2.15	5.5	
271-0510004	C3634 12DC	CABLE + DEUTSCH	12 DC	12 VDC	26	2.15	5.5	
271-0510207	C3607 12DC	DEUTSCH DT 04-2P	12 DC	12 VDC	26	2.15	5.5	
271-05104	C3601 13DC	DIN 43650 - ISO 4400	13 DC	13 VDC	26	2.00	6.5	
271-0511	C3601 24DC	DIN 43650 - ISO 4400	24 DC	24 VDC	26	1.10	22	
271-0511002	C3631 24DC	CABLES	24 DC	24 VDC	26	1.10	22	
271-05112	C3603 24DC	AMP JUNIOR	24 DC	24 VDC	26	1.10	22	
271-0511004	C3634 24DC	CABLE + DEUTSCH	24 DC	24 VDC	26	1.10	22	
271-0511207	C3607 24DC	DEUTSCH DT 04-2P	24 DC	24 VDC	26	1.10	22	
271-051101	C3601 27DC	DIN 43650 - ISO 4400	27 DC	27 VDC	26	1.00	28	
271-0512	C3601 48DC	DIN 43650 - ISO 4400	48 DC	V 48 DC	26	0.54	89	
271-0514	C3601 110DC	DIN 43650 - ISO 4400	110 DC	V 110 DC	29	0.27	413	
271-05110	C3601 24-50/60Hz RAC	DIN 43650 - ISO 4400	21.5 DC	V 21.5 DC	26	1.20	18	
271-0513	C3601 110-50/60Hz RAC	DIN 43650 - ISO 4400	98 DC	V 98 DC	29	0.29	338	
271-0515	C3601 230-50/60Hz RAC	DIN 43650 - ISO 4400	207 DC	V 207 DC	29	0.14	1430	